

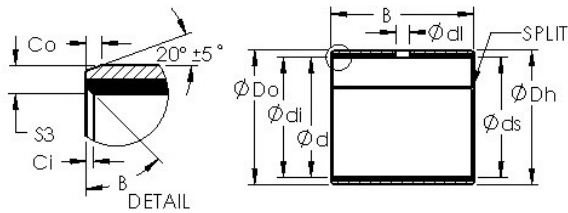

# BEARING SCIENCE & TECHNOLOGY CO.,LTD.



## AST AST40 22080 plain bearings

Bearing No. AST40 22080

Bore Diameter	220 mm
Outer Diameter	225 mm
Bearing Type	straight
Shaft Dia., Nominal (d)	220.0000
Shaft Size (ds) - 220 -0 / -0.072	220 0 / 0.072
Housing Bore Dia. (Dh)	225 +0.046 / +0
Bearing Outside Diameter, Nominal(Do)	225.000
Bearing Outside Diameter Tolerance (Do tol.)	225.21 / 225.13
Bearing Bore after Mounting (di)	200.216 / 200.07
Average Clearance (Cd)	0.1790
Wall Thickness (S3)	2.465
Bearing Length, Nominal (B)	80.000
Bearing Length Tolerance (B tol.) - +0 / -0.40	+0 / 0.40
OD Chamfer Length (Co)	1.800
ID Chamfer Angle (B deg.)	45
ID Chamfer Length (Ci)	0.600
Material	Steel shell with PTFE / Polymer Fiber lining

AST40 22080 Bearing 2D drawings and 3D CAD models