

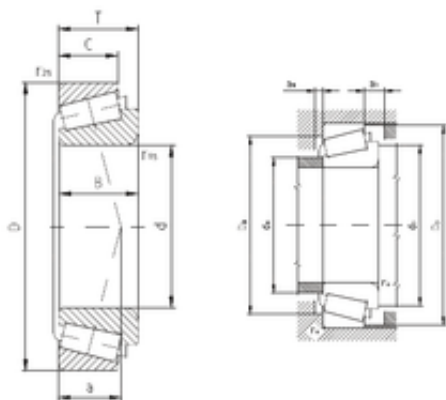

ZVL 30306A tapered roller bearings



Bearing No. 30306A

Size	30x72x20.75 mm
Bore Diameter	30 mm
Outer Diameter	72 mm
Width	20,75 mm
d	30 mm
D	72 mm
T	20,75 mm
B	19 mm
C	16 mm
a	15 mm
r1 min.	1,5 mm
r2 min.	1,5 mm
da max	38 mm
Da min	61 mm
Da max.	65 mm
db min	37 mm
Db min.	66 mm
ra max.	1 mm
Weight	0,4 Kg
Basic dynamic load rating (C)	59,5 kN
Basic static load rating (C0)	60,1 kN
(Grease) Lubrication Speed	5 600 r/min
(Oil) Lubrication Speed	7 500 r/min
Calculation factor (e)	0,32
Calculation factor (Y)	1,9

30306A Bearing 2D drawings and 3D CAD models