

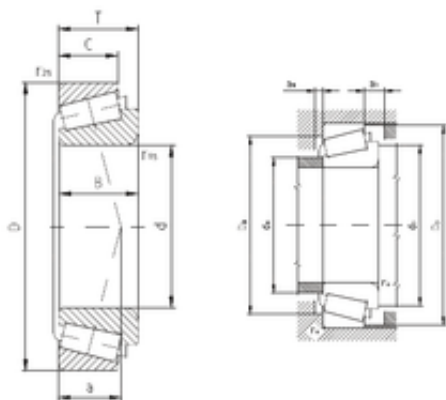

ZVL 33205A tapered roller bearings



Bearing No. 33205A

Size	25x52x22 mm
Bore Diameter	25 mm
Outer Diameter	52 mm
Width	22 mm
d	25 mm
D	52 mm
T	22 mm
B	22 mm
C	18 mm
a	14 mm
r1 min.	1 mm
r2 min.	1 mm
da max	30 mm
Da min	43 mm
Da max.	46 mm
db min	31 mm
Db min.	49 mm
ra max.	1 mm
Weight	0,229 Kg
Basic dynamic load rating (C)	49 kN
Basic static load rating (C0)	58,5 kN
(Grease) Lubrication Speed	7 500 r/min
(Oil) Lubrication Speed	10 000 r/min
Calculation factor (e)	0,35
Calculation factor (Y)	1,7

33205A Bearing 2D drawings and 3D CAD models