

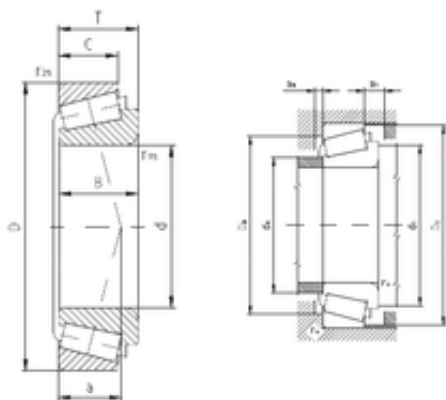

ZVL 32304A tapered roller bearings



Bearing No. 32304A

Size	20x52x22.25 mm
Bore Diameter	20 mm
Outer Diameter	52 mm
Width	22,25 mm
d	20 mm
D	52 mm
T	22,25 mm
B	21 mm
C	18 mm
a	13 mm
r1 min.	1,5 mm
r2 min.	1,5 mm
da max	27 mm
Da min	43 mm
Da max.	45 mm
db min	27 mm
Db min.	47 mm
ra max.	1 mm
Weight	0,267 Kg
Basic dynamic load rating (C)	45,6 kN
Basic static load rating (C0)	46 kN
(Grease) Lubrication Speed	8 400 r/min
(Oil) Lubrication Speed	11 000 r/min
Calculation factor (e)	0,3
Calculation factor (Y)	2

32304A Bearing 2D drawings and 3D CAD models