

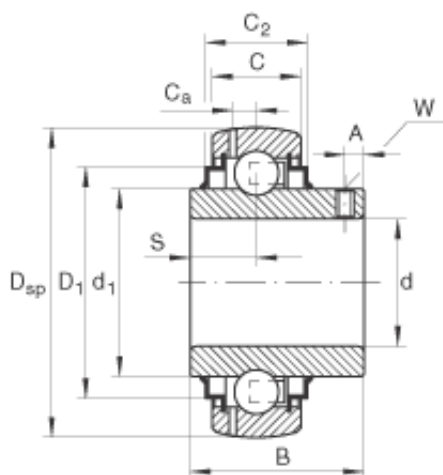

BEARING SCIENCE & TECHNOLOGY CO.,LTD.



INA GY1111-KRR-B-AS2/V deep groove ball bearings

Bearing No. GY1111-KRR-B-AS2/V

Size	42.8625x85x49.2 mm
Bore Diameter	42,8625 mm
Outer Diameter	85 mm
Width	49,2 mm
d	1 11/16 inch
d	42,8625 mm
D _{SP}	85 mm
B	49,2 mm
A	8 mm
C	22 mm
C ₂	25,7 mm
C _a	6,4 mm
D ₁	71,7 mm
d ₁	57,9 mm
S	19 mm
W	5/32 inch
m	0,7 kg / Weight
C _r	32500 N / Dynamic load rating (radial)
C _{0r}	20400 N / Static load rating (radial)
Category	Insert Bearings Spherical OD
Inventory	0.0
Manufacturer Name	SCHAEFFLER GROUP
Minimum Buy Quantity	N/A

GY1111-KRR-B-AS2/V Bearing 2D drawings and 3D CAD models



BEARING SCIENCE & TECHNOLOGY CO.,LTD.

Weight / Kilogram	0.877
Product Group	M06110
Inner Race Profile	Wide Inner Ring
Outer Race Profile	Spherical
Relubricatable	Yes
Seal Type	Double Land Riding Rubber Contact
Mounting Method	Set Screw
Rolling Element	Ball Bearing
Snap Ring	No
Long Description	1-11/16" Bore; Wide Inner Ring; Ball Bearing; 1-15/16" Length Thru Bore; 0.866" Outer Race Width; 3.347" Outside Diameter; Relubricatable; Double Land Riding Rubber Contact Seal; S
Inch - Metric	Inch
Other Features	Single Row Grub Screw
Category	Insert Bearings
UNSPSC	31171536
Harmonized Tariff Code	8482.10.50.00
Noun	Bearing
Keyword String	Insert
Manufacturer URL	http://www.ina.com
Manufacturer Item Number	GY1111KRRB
Weight / LBS	1.61
Bore	1.688 Inch 42.875 Millimeter
Outer Race Width	0.866 Inch 21.996 Millimeter
Length Thru Bore	1.937 Inch 49.2 Millimeter
Outside Diameter	3.347 Inch 85.014 Millimeter